

Motor Typ	Anbaumaße, mm																
	A	B	C	H	K	D	E	F	G	AB	AC	AD	BB	LD	DH	HD	L
KAE2A80	125	100	50	80	10	19	40	6	15,5	153	156	129	122	85	M6×16	209	301
KAE2A90S	140	100	57	90	10	24	50	8	20	173	176	136	155	83,5	M8×19	226	328,5
KAE2A90L	140	125	57	90	10	24	50	8	20	173	176	136	155	83,5	M8×19	226	353,5
KAE2A100L	160	140	63	100	12	28	60	8	24	205	202	149	176	83,5	M10×22	249	375
KAE2A112M	190	140	70	112	12	28	60	8	24	222	223	169	180	90	M10×22	281	394
KAE2A132S	216	140	89	132	12	38	80	10	33	256	263	188	180	102	M12×28	320	462
KAE2A132M	216	178	89	132	12	38	80	10	33	256	263	188	218	102	M12×28	320	500

Titel:	Maßblatt	
Type:	IE2 - B3	
		

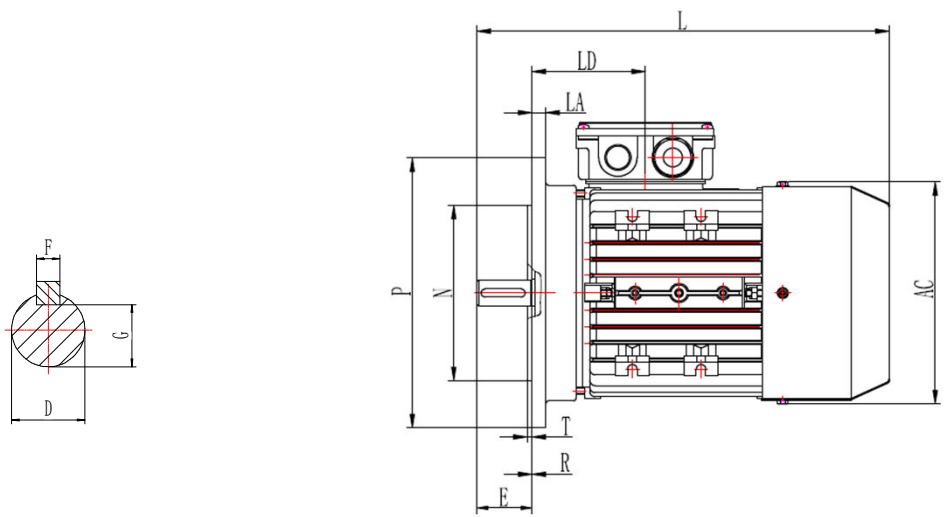

Motor Typ	Anbaumaße, mm																
	D	E	F	G	M	N	P	R	S	T	AC	AD	LA	LD	DH	HF	L
KAE2A80	19	40	6	15,5	165	130	200	0	12	3,5	156	129	10	85	M6×16	229	301
KAE2A90S	24	50	8	20	165	130	200	0	12	3,5	176	136	10	83,5	M8×19	236	328,5
KAE2A90L	24	50	8	20	165	130	200	0	12	3,5	176	136	10	83,5	M8×19	236	353,5
KAE2A100L	28	60	8	24	215	180	250	0	15	4	202	149	14	83,5	M10×22	274	375
KAE2A112M	28	60	8	24	215	180	250	0	15	4	223	169	14	90	M10×22	294	394
KAE2A132S	38	80	10	33	265	230	300	0	15	4	263	188	15	102	M12×28	338	462
KAE2A132M	38	80	10	33	265	230	300	0	15	4	263	188	15	102	M12×28	338	500

Titel:	Maßblatt
Type:	IE2 - B5



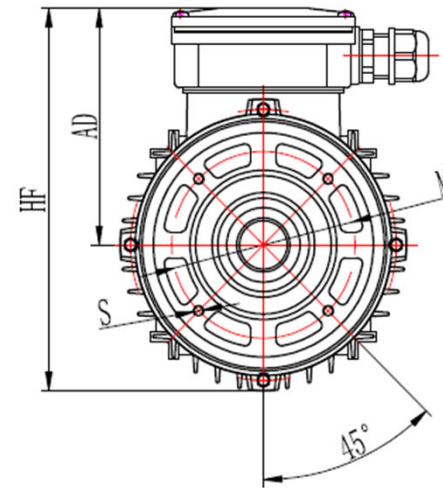
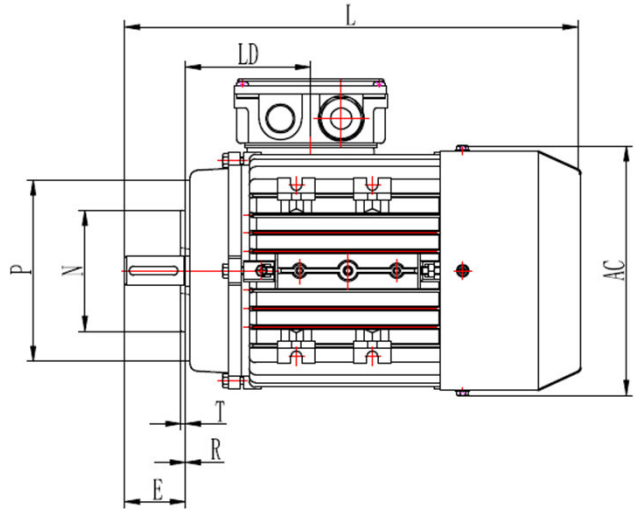
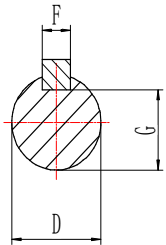

Motor Typ	Anbaumaße, mm															
	D	E	F	G	M	N	P	R	S	T	AC	AD	LD	DH	HF	L
KAE2A80	19	40	6	15,5	100	80	120	0	M6	3	156	129	85	M6×16	207	301
KAE2A90S	24	50	8	20	115	95	140	0	M8	3	176	136	83,5	M8×19	224	328,5
KAE2A90L	24	50	8	20	115	95	140	0	M8	3	176	136	83,5	M8×19	224	353,5
KAE2A100L	28	60	8	24	130	110	160	0	M8	3,5	202	149	83,5	M10×22	250	375
KAE2A112M	28	60	8	24	130	110	160	0	M8	3,5	223	169	90	M10×22	280,5	394
KAE2A132S	38	80	10	33	165	130	200	0	M10	3,5	263	188	102	M12×28	319,5	462
KAE2A132M	38	80	10	33	165	130	200	0	M10	3,5	263	188	102	M12×28	319,5	500

Titel:	Maßblatt	
Type:	IE2 - B14A	
		

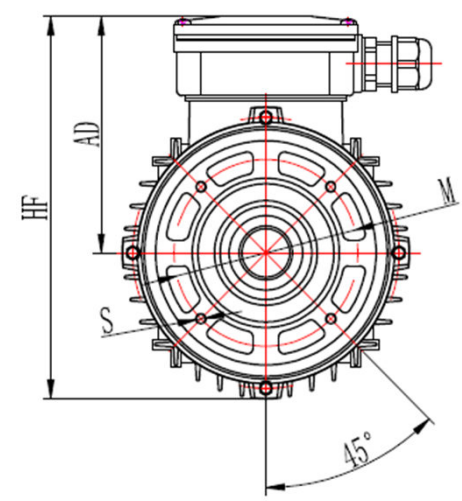
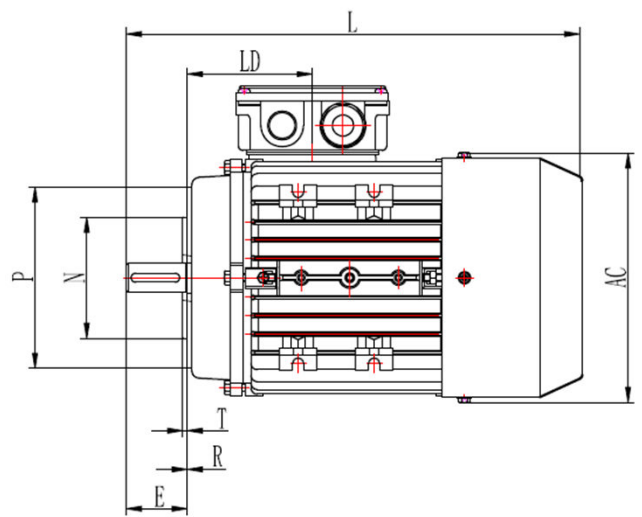
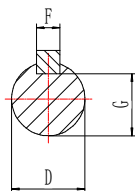

Motor Typ	Anbaumaße, mm															
	D	E	F	G	M	N	P	R	S	T	AC	AD	LD	DH	HF	L
KAE2A80	19	40	6	15,5	130	110	160	0	M8	3,5	156	129	85	M6×16	209	301
KAE2A90S	24	50	8	20	130	110	160	0	M8	3,5	176	136	83,5	M8×19	224	328,5
KAE2A90L	24	50	8	20	130	110	160	0	M8	3,5	176	136	83,5	M8×19	224	353,5
KAE2A100L	28	60	8	24	165	130	200	0	M10	3,5	202	149	83,5	M10×22	249	375
KAE2A112M	28	60	8	24	165	130	200	0	M10	3,5	223	169	90	M10×22	280,5	394
KAE2A132S	38	80	10	33	215	180	250	0	M12	4	263	188	102	M12×28	319,5	462
KAE2A132M	38	80	10	33	215	180	250	0	M12	4	263	188	102	M12×28	319,5	500

Titel:	Maßblatt
Type:	IE2 - B14B



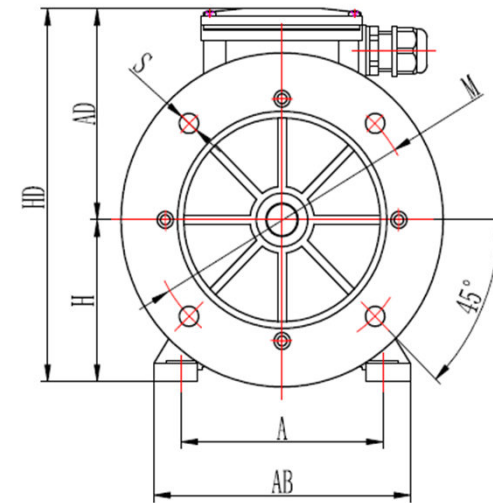
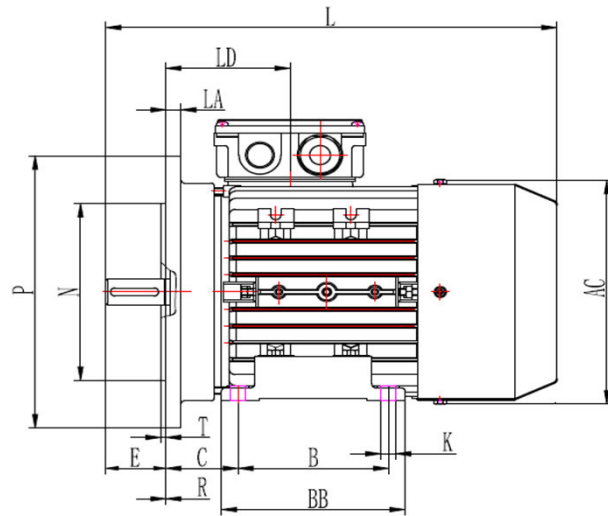
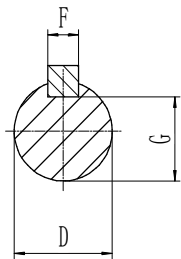



Motor Typ	Anbaumaße, mm (R = 0)																					
	A	AB	B	BB	C	D	E	F	G	H	K	M	N	P	S	T	AC	AD	LA	LD	DH	L
KAE2A80	125	153	100	122	50	19	40	6	15,5	80	10	165	130	200	12	3,5	156	129	10	85	M6×16	301
KAE2A90S	140	173	100	155	57	24	50	8	20	90	10	165	130	200	12	3,5	176	136	10	83,5	M8×19	328,5
KAE2A90L	140	173	125	155	57	24	50	8	20	90	10	165	130	200	12	3,5	176	136	10	83,5	M8×19	353,5
KAE2A100L	160	205	140	176	63	28	60	8	24	100	12	215	180	250	15	4	202	149	14	83,5	M10×22	375
KAE2A112M	190	222	140	180	70	28	60	8	24	112	12	215	180	250	15	4	223	169	14	90	M10×22	394
KAE2A132S	216	256	140	180	89	38	80	10	33	132	12	265	230	300	15	4	263	188	15	102	M12×28	462
KAE2A132M	216	256	178	218	89	38	80	10	33	132	12	265	230	300	15	4	263	188	15	102	M12×28	500

Titel:	Maßblatt
Type:	IE2 - B35

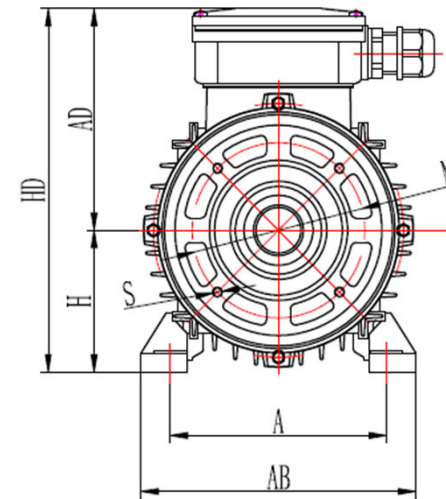
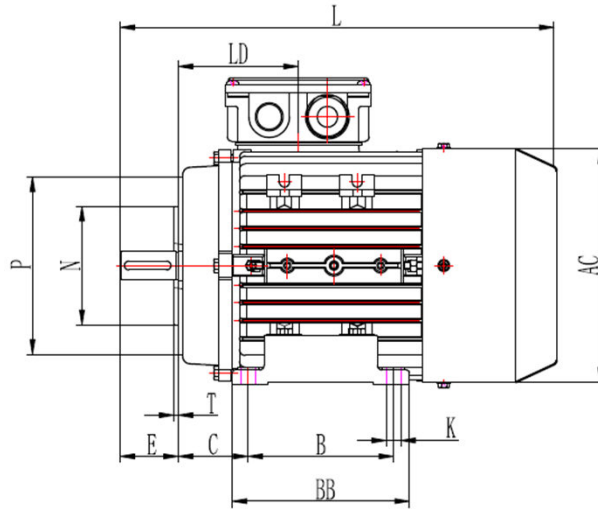
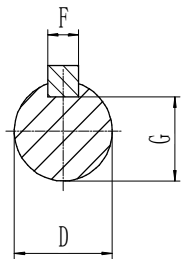



Motor Typ	Anbaumaße, mm (R = 0)																				
	A	AB	B	BB	C	D	E	F	G	H	K	M	N	P	S	T	AC	AD	LD	DH	L
KAE2A80	125	153	100	122	50	19	40	6	15,5	80	10	100	80	120	M6	3	156	129	85	M6×16	301
KAE2A90S	140	173	100	155	57	24	50	8	20	90	10	115	95	140	M8	3	176	136	83,5	M8×19	328,5
KAE2A90L	140	173	125	155	57	24	50	8	20	90	10	115	95	140	M8	3	176	136	83,5	M8×19	353,5
KAE2A100L	160	205	140	176	63	28	60	8	24	100	12	130	110	160	M8	3,5	202	149	83,5	M10×22	375
KAE2A112M	190	222	140	180	70	28	60	8	24	112	12	130	110	160	M8	3,5	223	169	90	M10×22	394
KAE2A132S	216	256	140	180	89	38	80	10	33	132	12	165	130	200	M10	3,5	263	188	102	M12×28	462
KAE2A132M	216	256	178	218	89	38	80	10	33	132	12	165	130	200	M10	3,5	263	188	102	M12×28	500

Titel:	Maßblatt	
Type:	IE2 - B34A	
		

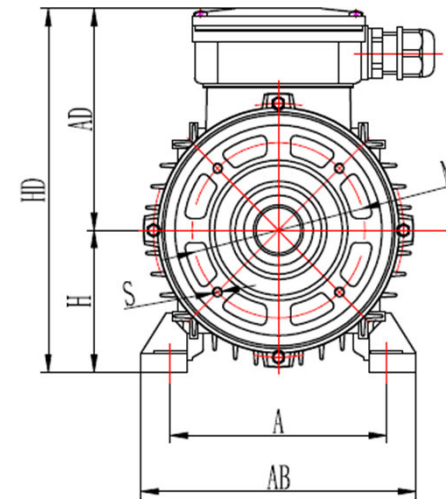
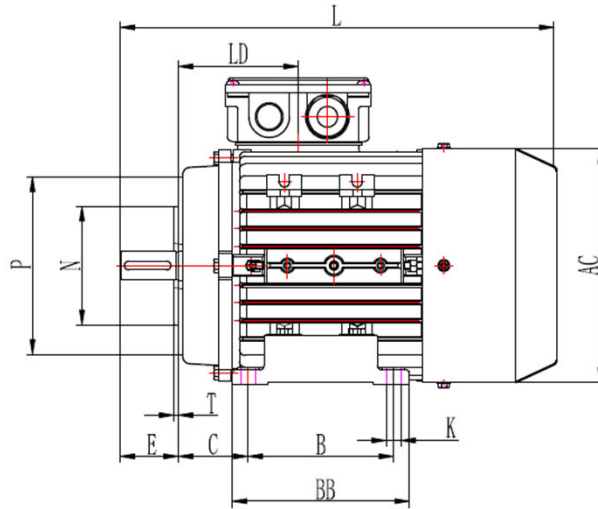
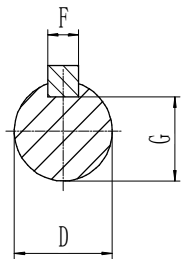

Motor Typ	Anbaumaße, mm (R = 0)																				
	A	AB	B	BB	C	D	E	F	G	H	K	M	N	P	S	T	AC	AD	LD	DH	L
KAE2A80	125	153	100	122	50	19	40	6	15,5	80	10	130	110	160	M8	3,5	156	129	85	M6×16	301
KAE2A90S	140	173	100	155	57	24	50	8	20	90	10	130	110	160	M8	3,5	176	136	83,5	M8×19	328,5
KAE2A90L	140	173	125	155	57	24	50	8	20	90	10	130	110	160	M8	3,5	176	136	83,5	M8×19	353,5
KAE2A100L	160	205	140	176	63	28	60	8	24	100	12	165	130	200	M10	3,5	202	149	83,5	M10×22	375
KAE2A112M	190	222	140	180	70	28	60	8	24	112	12	165	130	200	M10	3,5	223	169	90	M10×22	394
KAE2A132S	216	256	140	180	89	38	80	10	33	132	12	215	180	250	M12	4	263	188	102	M12×28	462
KAE2A132M	216	256	178	218	89	38	80	10	33	132	12	215	180	250	M12	4	263	188	102	M12×28	500

Titel:	Maßblatt	
Type:	IE2 - B34B	
